



CITROËN C4 SpaceTourer

Vehicle instruction manual: in the glove compartment

Fuel: Gasoline E10 / EURO 95

Tyre pressure: see sticker on the pillar of the driver's door

Start the car

Shift to neutral and insert the electronic key into the slot. Keep the clutch pedal depressed and briefly press the start/stop button.

Reverse gear



Pull up the collar on the gear lever, and move the lever left and forward.

Air conditioning/Heating

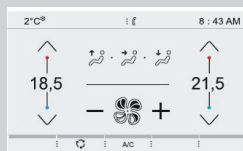

To adjust, use the Airco menu on the touch screen.

The front window demister/defroster switch and the rear window defroster switch are located left of the touch screen.

Adjust side mirrors

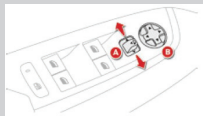

The controls are located on the dashboard, left on the steering wheel:

A. Select left or right mirror. You can then adjust the mirror in all directions. Move the switch back to its neutral position after adjusting.

Cruise control



Use the controls on the steering wheel's left side:

1. Select cruise control mode
2. Reduce set speed
3. Increase set speed
4. Turn on/pause cruise control
5. Toggle list of programmed speeds

Speed limit

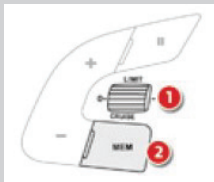

Use the controls on the steering wheel's left side:

1. Select speed limit mode (turn dial upwards)
2. Save set speed

Handbrake



This car features an automatic handbrake, which engages automatically when the engine shuts down and releases when you start driving.

12Volt socket



There is a socket in the storage compartment near the central compartment. There are two additional sockets on the second row and a socket near the back seat or the boot.

SOS button



Please refrain from using the SOS button or the assistance button on the dashboard. In case of a breakdown or accident please contact cambio with the yellow button on the on board computer.

Open the boot

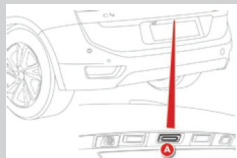

Use the button on the electronic key/remote control or use the dedicated button (A) inside the car.

Park assist



This vehicle has a park assist system in the rear. When in reverse gear, a buzzer will beep faster as you get closer to an obstacle.

Fuel cap

On the passenger side at the back. To open, press on the left edge of the cover. The car has to be unlocked.

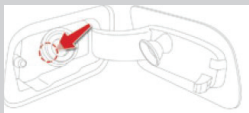

Steering lock

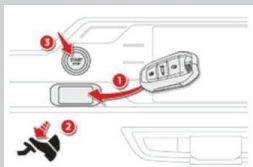

Wiggle the steering wheel back and forth while pushing the start/stop button to release the lock.

Headlights/Fog Lights

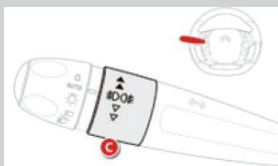
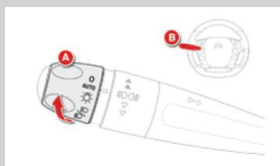

Headlights: In automatic mode your headlights turn on automatically when it gets dark and they turn back off when there is enough ambient light.

Rotate the dial (A) at the end of the lever (B) left of the steering wheel forward two clicks to manually operate the headlights.

Pull the lever (B) towards you to operate the high beams.

Fog Lights: Front: rotate the collar (C) forward one click to turn on the front fog lights. A control light appears on the dashboard.

Rear: rotate the collar (C) forward two clicks to turn on the rear fog lights. A second control light appears on the dashboard.

Spare wheel



The spare wheel is stored at the underside of the car, at the back. A hex and a wheel wrench are kept in a storage compartment behind the driver's seat. See instruction manual for further instructions.

GPS (touch screen)



Tap the NAV button to start navigation. You can then change the settings on the touch screen.

Window wipers

Front wipers:

Push the lever right of the steering wheel upward to select either of the following modes:

0 = off

1 = intermittent

1 = normal speed (moderate rain)

2 = high speed (heavy rain)

Push the lever down = single wipe or Auto (the wipers turn on automatically when it rains). To switch off automatic wiping mode, push the lever upward and return to setting 0.

Pull the lever towards you to spray and wipe.

Rear wipers:

Rotate the dial (B) forward one click to operate the rear wipers (intermittent). Rotate the dial further forward to spray and wipe.

