



OPEL Astra

Vehicle instruction manual: in the glove compartment

Fuel: Diesel

Tyre pressure: see sticker on the pillar of the driver's door

Reverse gear



Pull up the collar on the gear lever, and move the lever left and forward.

Air conditioning / Heating



To turn on the air conditioning press the A/C button on the far left.

Use the control on the bottom left to close off outside air intake (in tunnels, etc.)

Use the left and right rotary dials to set the desired temperature for the driver's and passenger seat.

Use the buttons in the middle to direct the airflow (windshield, feet,...). Press the AUTO button if you want the air distribution and fan speed to be adjusted automatically.

Adjust side mirrors



Use the controls by the handle of the driver's door.

Rotate the dial left or right to select the respective mirror. Then push the switch up/down/left/right until the mirror is in the desired position.

Cruise control



The cruise control panel is located on the steering wheel's left side.

Select cruise control: push the button on the top right to select cruise control. Set speed: press the gas pedal to accelerate until you reach the desired speed. Then turn the thumb wheel down and select "SET".

Increase speed: turn the thumb wheel up to "Res+"/

Reduce speed: turn the thumb wheel down to "Set/-".

Switch off cruise control: push the button on the left of the panel to pause cruise control. Push the button on the top right to deactivate cruise control.

Cruise control turns off automatically if you depress the brake or clutch pedal, or when driving too slowly.

Park assist



Push the park assist button to activate. The LED in the button lights up when active. Sensors measure the distance between the vehicle and any obstacles behind you. A beep will sound if you come too close.

Steering lock



Turn the ignition key and then the steering wheel to release the lock.

Handbrake



up on the dashboard. Release the handbrake immediately!

To release the handbrake pull the lever up slightly and push the button at the end. You can then lower the handbrake lever. If the handbrake is engaged whilst riding, a red warning sign lights

Start/stop system



This car has a start/stop function to reduce fuel consumption. When you stop for a red light or in traffic, and you put the gear lever in neutral and release the clutch pedal, the engine will

turn off automatically. The engine turns back as soon as you engage the clutch pedal. Use the button (A off) to deactivate this function.

GPS



Press the **NAVI** button on the bottom left. Then use the multifunction button as shown on the image to select and confirm. Select by rotating the central dial, confirm by pushing the same button.

Fuel cap

On the passenger side at the back. To open, press on the left edge of the cover. Now unscrew the cap.



Speed limiter



The speed limit panel is located on the left side of the steering wheel.

Select speed limiter: push the button on the bottom right to select speed limit mode.

Set speed: accelerate or slow down to the desired speed. Then turn the thumb wheel down to "SET".

Increase speed: turn the thumb wheel upward to "Res/+".

Reduce speed: turn the thumb wheel down to "Set/-".

Turn off speed limiter: push the button on the left to pause **thespeed limiter**. Push the button on the top right to deactivate the speed limit mode.

Headlights/Fog lights

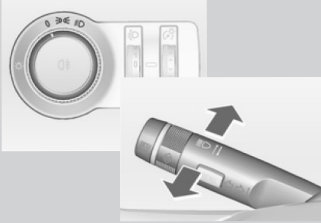

Headlights: rotate the dial at the end of the lever left of the steering wheel forward two clicks to turn on the **headlights** (regular lights for nighttime driving). Pull the lever towards you to operate the high beams. A control light appears on the dashboard, indicating if the headlights (green) or high beams (blue) are active.

Fog lights: Front: rotate the dial (**B**) forward one **click** to operate the front fog lights. A control light appears on the dashboard.
Rear: rotate the dial (**C**) forward two clicks to operate the rear fog lights. A second control light appears on the dashboard.



Windscreen wipers

Front wipers:

Push the lever right of the steering wheel upward to select one of the following-modes:

- 0 = off
- 1 = intermittent wipe (rotate the dial at the end of the lever to adjust the speed)
- 2 = normal speed (moderate rain)
- 3 = high speed
- 4 = push lever down = single wipe

Pull the lever to activate the windscreen washer.

You can also use the AUTO setting. The wipers will engage when the

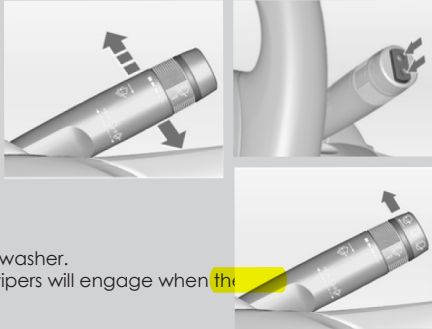

Rear wipers:

Use the rocker switch to operate the rear wipers. Switch facing upwards = continuous wipe

Switch facing downwards = intermittent wipe

Neutral position = wipers off

Spray:

Pull the lever towards you to spray and wipe the front windscreen.

Push the lever away from you to spray the rear windscreen.

12 Volt socket



There is a 12 Volt socket in the central console, in front of the gear lever.

Spare wheel



A spare wheel is stored under the boot floor, along with a wheel wrench and a jack. See instruction manual for further instructions.