



## PEUGEOT 308

Vehicle instruction manual: in the glove compartment.

Fuel: Gasoline **E10**/EURO95

Tyre pressure: see sticker on the pillar of the driver's door.

### Adjust side mirrors

The controls are on the driver's door:

**A** Select left or right mirror

**B** You can then adjust the mirror in all directions.

Please move the switch back to its neutral position after adjusting.

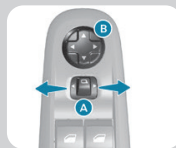

### Reverse gear



**Pull up** the ring on the gear lever and **move up left**.

### Handbrake



To release the hand brake pull up slightly and press the button at the end. Then you can lower the handbrake lever.

If the hand brake is engaged whilst riding, a red warning sign lights up on the dashboard **(!)**: release the handbrake immediately!

### Airco/Heating

To adjust, use the Airco Menu on the touch screen.

**1** desired temperature.

**2** fan speed.

**3** air distribution control (windscreen, feet, ...).

**4** switch on / off air conditioning.

**5** automatic program.

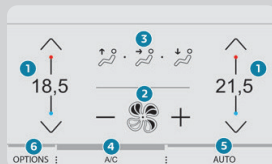

### Defroster



Front window defroster – button below the touch screen



Rear window defroster – button below the touch screen

### Steering lock

To release the lock, turn the ignition key and then the steering wheel.

### GPS (touchscreen)



Press "Navigation" to display the main page. Enter navigation settings and choose a destination.

### Cruise control

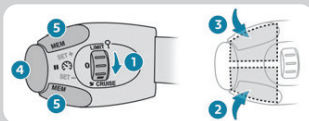

Use the controls on the steering wheel's left side:

1. Select cruise control mode
2. Reduce set speed
3. Increase set speed
4. Activate/deactivate cruise control
5. Pause cruise control

The cruise control settings are displayed on the dashboard. See car manual for detailed instructions.

**i** Braking disables the cruise control.

### 12 Volt socket

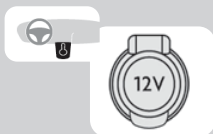

This is located at the bottom of the dashboard on the right.

### Speed limiter



Use the controls on the steering wheel's left side:

1. **Select** speed limit mode (turn dial upwards)
2. **Save** set speed

### Front wipers

Push the lever right of the steering wheel upward to select either of the following modes:

- |             |  |
|-------------|--|
| <b>2</b>    | Fast wiping (heavy rain)   |
| <b>1</b>    | Normal wiping (moderate rain)  |
| <b>Int</b>  | Intermittent wiping  |
| <b>0</b>    | Switching off  |
| <b>↓</b>    | Single wipe  |
| <b>AUTO</b> | Automatic wiping (the wipers turn on automatically when it rains). To switch off automatic wiping mode, push the lever upward and return to setting 0. |

### Rear wipers

Rotate the dial forward one click to operate the rear wipers (intermittent).



**Pull the lever towards you to spray and wipe.**

**Rotate the dial further forward to spray and wipe.**



## Headlights

rotate the dial at the end of the lever left of the steering wheel to select the correct setting:

**0**

No lights

**AUTO**

Automatic



Parking lights



**Low beams and high beams**

**Pull** the lever **towards** you (in low beam setting) to operate the high beams.



## Fog lights

**Front:** rotate the dial one click forward/upward to turn on the front fog lights. A control light appears on the dashboard.

**Rear:** rotate the dial forward two clicks to switch on the rear fog lights. A second control light appears on the dashboard.



**Switching off** can be done by turning the same ring back down.

## Spare wheel



The spare wheel is stored **under the boot floor**, you can find a compressor kit and a tow hook.

## Open the boot



To open, **pull the handle at the base of the hatch** below the Peugeot logo.

## Parkeerhulp

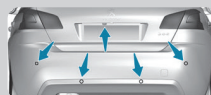

This vehicle has a park assist system in the rear. When **in reverse gear**, a buzzer will beep faster as you get closer to an obstacle.

## Fuel cap

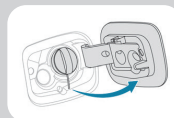

The fuel cap is **on the passenger's side**. You can open the cover by simply pushing on it.