



CITROËN Jumpy

Vehicle instruction manual: in the glove compartment

Fuel: **Diesel**

Tyre pressure: see sticker on the pillar of the driver's door

Loadspace dimensions: Max depth: 216 cm | Max width: 125 cm | Max height: 122 cm

12 Volt socket



There are several 12 Volt sockets depending on the car model.

Air conditioning/Heating



A/C = airco (the led in the button lights up when active)
Left dial = airflow (increase or decrease fan speed)
Right dial = set temperature
Leftmost button = outside/inside air intake*

* Outside air intake / air recirculation

The recirculation mode serves to close off outside air intake in case of odors or dust. Remember to switch back to outside air mode as quickly as possible to reduce the risk of stale air or condensation forming on the windows.

The remaining three buttons = air distribution (windscreen, face, feet).

Adjust side mirrors



Use the controls on the driver's door.

A. select left or right mirror. Move the switch to its neutral position after adjusting.

B. Adjust.

Tip: use button A to fold the side mirrors.

Cruise control

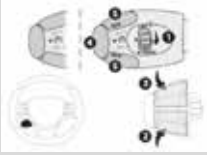

Use the controls on the steering wheel's left side:

1. Select/turn off cruise control (turn the dial downwards)
2. Reduce set speed
3. Increase set speed
4. Pause/resume selected setting

Cruise control mode lights up on the dashboard.

Speed limiter

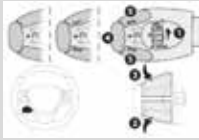

Use the controls on the steering wheel's left side:

1. Select speed limit mode (turn the dial upwards)
2. Reduce set speed
3. Increase set speed
4. Set/pause speed limiter mode

Spare wheel



The spare wheel sits under the car, at the rear. A jack and a wheel wrench are stored under the driver's seat.

Handbrake



To release the handbrake pull the lever up slightly and push the button at the end. You can then lower the handbrake lever.

If the handbrake is engaged whilst riding, a red warning sign lights up on the dashboard. Release the handbrake immediately!

Open the boot

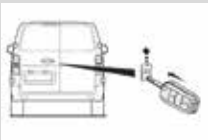

Pull the lever on the right-hand door. To open the second door, pull the lever on the inside of the left-hand door (near the handle of the right-hand door).

To close the boot, close the left-hand door first, then the right-hand door.

Park assist

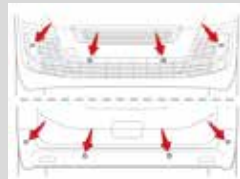

This vehicle features a park assist system in the rear.

When in reverse gear, a buzzer will beep faster as you get closer to an obstacle. Visual cues will be displayed on the screen near the central console.

Be sure to brake in time!

Fuel cap

On the driver's side at the back, just above the rear wheel. Pull open the cover and unscrew the cap with the ignition key.



Reverse gear

Move the gear lever down and left.

Steering lock

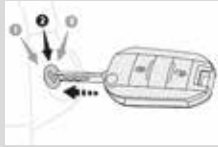

Turn the steering wheel and the ignition key simultaneously to release the lock.

Headlights/Fog lights



Headlights: rotate the dial all the way down to manually operate the headlights (regular lights for nighttime driving). Pull the lever towards you to operate the high beams. In Auto mode, the headlights operate automatically depending on ambient light levels.

Fog lights: rotate the dial forward one click to turn on the front fog lights, and forward two clicks to turn on the rear fog lights. A control light appears on the dashboard



Window wipers



Front wipers:

Use the lever to set the speed:
0 = off
I = intermittent

1 = normal speed (moderate rain)
2 = high speed (heavy rain)
Push the lever down = single wipe
Auto = the wipers will respond and adapt automatically to the ambient rain conditions.

Windscreen washer:

Rotate the dial down one click to wipe, and two clicks to spray and wipe.

SOS button



Please refrain from using the SOS button or the assistance button on the dashboard. In case of a breakdown or accident please contact cambio with the yellow button on the on board computer.

AdBlue reservoir



The Adblue reservoir is located next to the fuel tank and has a blue cap.

It is refilled by cambio. Refilling it yourself is only allowed in case of urgency (notification on the dashboard) and after contacting the cambio call center.