



CITROËN C3

Vehicle instruction manual: in the glove compartment

Fuel: Gasoline E10 / EURO95

Tyre pressure: see sticker on the pillar of the driver's door

Reverse gear



Move the gear lever down and right.

Air conditioning/Heating



Tap the button on the bottom left of the touch screen to adjust air conditioning and heating. Adjust the settings on the screen:

- Adjust air flow
- Set temperature
- Air distribution (front window, feet,...)
- Turn air conditioning on or off
- Outside air intake or air recirculation (in tunnels, etc.)



Front window defroster – button below the touch screen
Rear window defroster – button below the touch screen



Adjust side mirrors

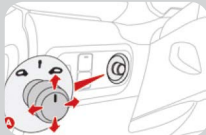

The controls are located on the dashboard, left of the steering wheel:

- A. Select left or right side mirror. You can now adjust the mirror in all directions. Set the arrow back in the middle after adjusting.

Starten



Some C3 New (the latest ones) have a **Start/Stop button**.

1. Press the coupling and hold the pedal down.
2. Press the **START/STOP button**.
3. You can put the key in one of the storage compartments under the display.

Cruise control

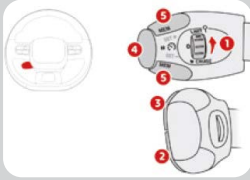

Use the controls on the steering wheel's left side:

1. **Select cruise control mode** (turn dial downwards)
2. **Reduce set speed**
3. **Increase set speed**
4. **Turn cruise control on or off**
5. **Cruise control active/paused**

The cruise control settings are displayed on the dashboard. See car manual for detailed instructions.

Speed limit

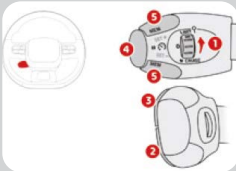

Use the controls on the steering wheel's left side:

1. **Select speed limit mode** (turn dial upwards)
2. **Reduce set speed**
3. **Increase set speed**
4. **Turn speed limit mode on or off**

The speed limit settings are displayed on the dashboard. See car manual for detailed instructions.

Handbrake

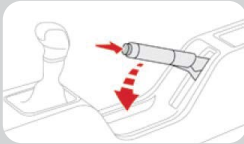

To **release the handbrake** pull the lever up slightly and **push the button at the end**. You can then **lower the handbrake lever**. If the handbrake is engaged **whilst riding**, a red warning sign lights up on the dashboard. **Release the handbrake immediately!**



Open the boot

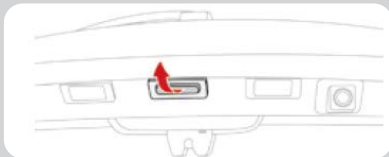

Normal operation. To open, pull the handle at the base of the hatch.

Park assist

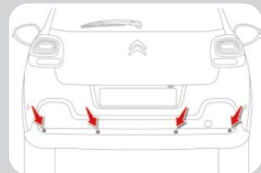

This vehicle features a **park assist system in the rear**. When in reverse gear, a buzzer will beep faster as you get closer to an obstacle. Visual cues will be displayed on the screen near the central console. Be sure to **brake in time!**

GPS (touch screen)



To start the GPS function tap the middle button on the left of the screen. Tap MENU to enter a destination.

Fuel cap (always use gasoline
EURO95/E10)

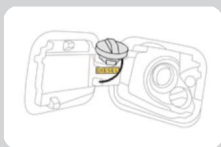

On the driver's side at the back. You can place the cap in the dedicated holder on the fuel lid while fuelling.

12 Volt socket

There is a socket at the bottom half of the dashboard on the left.



Headlights/Fog lights

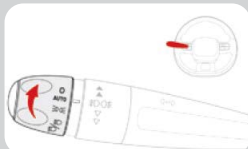

Headlights

rotate the dial at the end of the lever left of the steering wheel to select the correct setting:

- **Automatic**
- **Parking lights only**
- **Headlights**

Pull the lever towards you (in headlights setting) to operate the high beams.

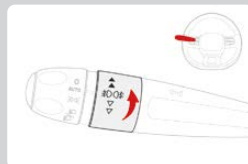

Fog lights

Front: rotate the dial one click forward/upward to turn on the front fog lights. A control light appears on the dashboard.

Rear: rotate the dial forward two clicks to switch on the rear fog lights. A second control light appears on the dashboard.

Spare wheel

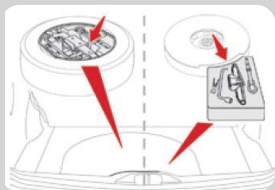

The spare wheel is stored **under the boot floor**, along with a **jack and wheel wrench**. See instruction manual for further instructions.

Window wipers

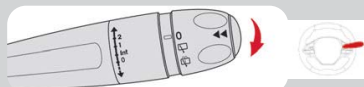

Front wipers: Push the lever right of the steering wheel upward, to select either of the following modes:

0 = off

1 = intermittent

1 = normal speed (moderate rain)

2 = high speed (heavy rain)

Auto = turns on automatically when it rains

Push the lever down = single wipe

Pull the lever toward you to spray and wipe.

Rear wipers: Rotate the dial forward one click to operate the rear wipers (intermittent). Rotate the dial another click forward to spray and wipe.

SOS button



Please **refrain from using the SOS button or the assistance button** on the dashboard. In case of an emergency, this function automatically notifies the emergency services. If it is not an emergency, it is better to contact the (cambio) center yourself in case of a breakdown or accident.