



Hyundai I20

Vehicle instruction manual: in the glove compartment

Fuel: Gasoline E10 / EURO95

Tyre pressure: see sticker on the pillar of the driver's door

Before starting your journey

Before starting, have you checked the following things?

- Have you answered the question about any damage in the cambio app?
- Have you answered the question about interior and exterior cleanliness in the cambio app?

Adjusting the interior and exterior mirrors

Exterior mirrors:

The controls are located on the driver's door handle. Select the mirror using switch **1**, then adjust it to the desired position using button **2**. Return the switch to the neutral position after adjusting.



Interior mirror:

Adjust the interior mirror so that the center of the rear window is visible in the middle of the mirror before driving. Pull the lever at the bottom towards you to activate the night mode and reduce glare. Visibility is slightly reduced in night mode.



Starting the vehicle

Ignition key

- The key is embedded in the remote. Press the button to unfold the ignition key.
- To unlock the steering wheel, turn the ignition key while turning the steering wheel.



Start the engine

Keep your right foot on the brake and turn the key all the way to start the engine.

Handbrake

Release the handbrake by pulling the lever up slightly while pressing the button at the end. Then lower the lever completely (the red warning light goes out).



On the road

Reverse gear:

Pull the ring under the top part of the gear shift up and move the gear shift first to the left and then forwards.



Park assist

This vehicle features a **park assist system in the rear**. When in reverse gear, a buzzer will beep faster as you get closer to an obstacle. **Visual cues will be displayed** on the screen near the central console. Be sure to **brake in time!** Right next to the gear lever, there is a button to activate the rear-view camera.



Ventilation and air conditioning controls:

1. Temperature
2. Airflow level (turn the outer ring)
3. Air circulation mode selection
4. Recirculation (on) or outside air (off)
5. Air conditioning (A/C) on/off
6. Rear window defrost (press the center of the button)



Cruise control / Speed limit

 (1) **Activate the Speed Limiter** by pressing the button on the right side of the steering wheel.

- + (2) increase maximum speed
- (2) decrease speed / activate speed limiter

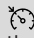
 (1) **Activate the cruise control** by pressing the button on the right side of the steering wheel.

- + (2) increase speed
- (2) decrease speed / activate cruise control

 (3) The function switches off when you press the brake pedal or button.

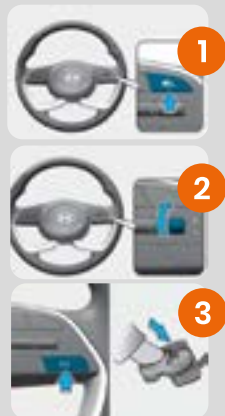

Headlights/ Fog lights

Lights:

Turn the outer left selector to the desired position for the standard lights:



= dipped beam headlights



= daytime running lights

Auto = automatic

0 = Off

Push the lever forward (in position 0) to switch the high beam on or off.

To deactivate the high beam, pull the lever back towards you.



Fog lights:

Shift the second selector down or up to activate or deactivate the front or rear fog lights.

Wipers

(A) Front:

2 = Fast wipe

1 = slow wipe

--- = Auto (with rain sensor)

0 = Off

v = 1 wipe

Pull the lever **toward you** to spray and wipe.

(B) Use the central slider on the control lever to adjust the wiper interval length.

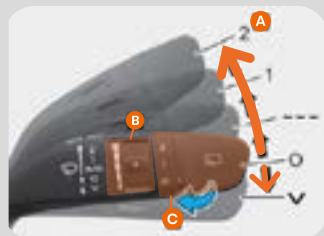

(C) Rear wipers:

Set the switch to the desired position to operate the rear wiper. You can adjust the intensity from high to low:

0 = Off

1 = Slow

2 = Fast

Push the lever forward to spray and wipe.

SOS button

Please **refrain from using the SOS button or the assistance button** on the dashboard. In case of an emergency, this function automatically notifies the emergency services. If it is not an emergency, it is better to contact the (cambio) call center yourself in case of a breakdown or accident.



Fuel cap

(always use gasoline EURO95/E10)

At the rear right. To open the fuel flap, press the flap itself. While refueling, hang the fuel cap on the hook inside the flap. After refueling, tighten the fuel cap until it is securely fastened.



Spare wheel

The spare wheel is stored **under the boot floor**, along with a **jack and wheel wrench**. See instruction manual for further instructions.



Navigation (Touchscreen)

Activate the GPS by pressing the "NAV" button. You will find this button below the touchscreen.

12 Volt socket and USB

These elements are located at the bottom of the dashboard. Note: the USB-C port is used only for charging a phone, while the USB-A port allows only the smartphone screen mirroring, for example to use GPS.



Car alarm

This vehicle may be equipped with a car alarm. If the alarm is triggered, switch it off by unlocking the vehicle using the unlock button on the key (remote control).